

SURVEYOR'S STATEMENT

STATE OF ILLINOIS) SS
COUNTY OF STARK)

We, the Wallace Engr. & Land Surveying Co., Inc., do hereby state that we have Surveyed the a part of Lot 20 of the Assessor's Sub. of the SE 1/4 of Section 24, T13N, R5E of the 4th P.M., Stark County, Illinois.

-We further state that the accompanying Plat is a true and correct representation of said Survey as made by us and that this professional service conforms to the current Illinois minimum standards for a boundary survey. All distances are given in feet and decimals of foot and bearings are for the purpose of description only. Distances shown in parentheses are of record. Distances shown in brackets are of record and as measured. Clear title to any land lying between deed lines and existing fences or field lines may be in question.

All buildings, surface and subsurface improvements, on and adjacent to the site are not necessarily shown. No attempt has been made, as a part of this



Farm: 138
Tract: 791



GOSHEN

HENRY COUNTY

T.13N.-R.5E.

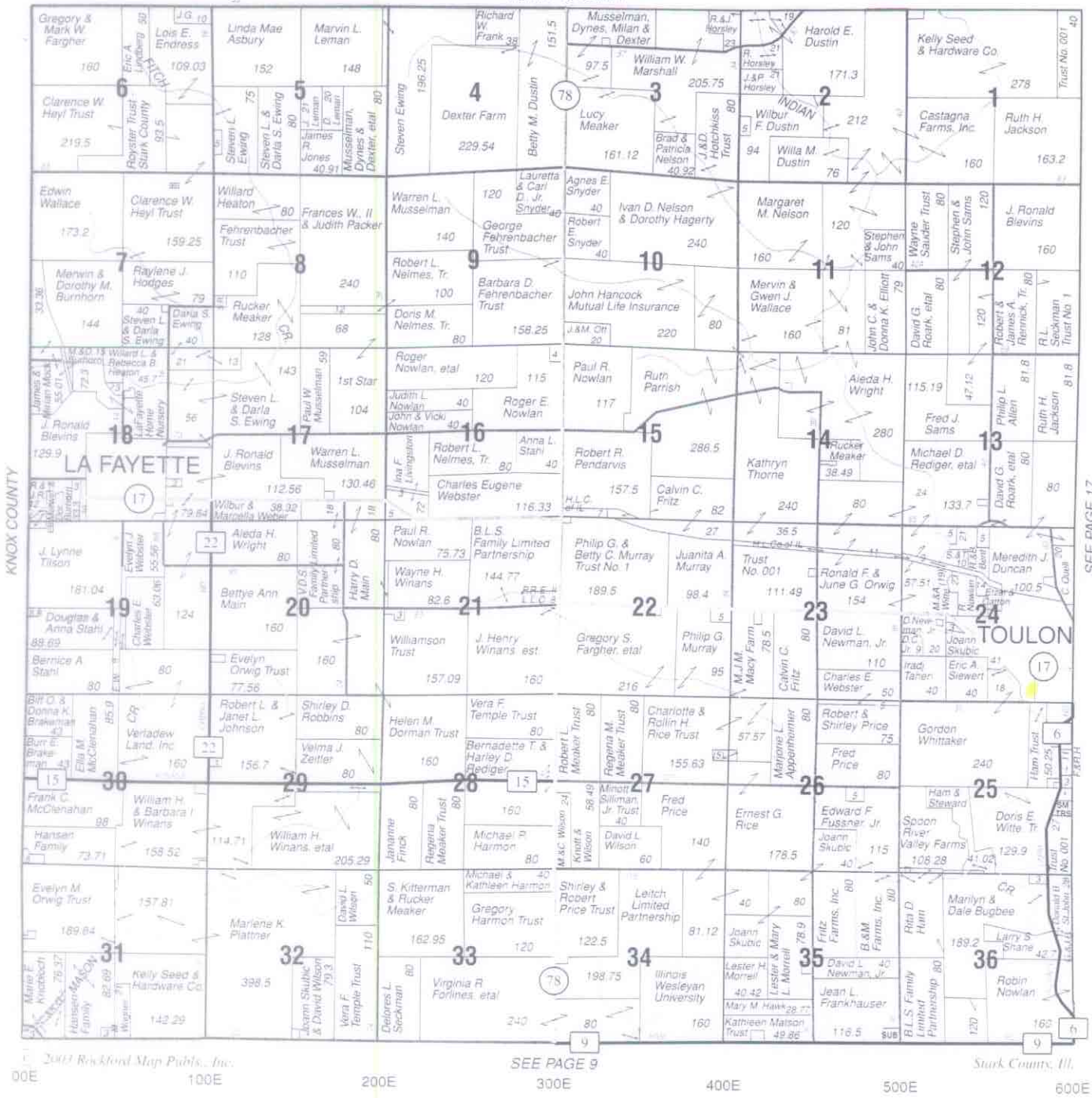

© 2001 Rockford Map Pubs., Inc.

SEE PAGE 9

Stark County, Ill.

00E 100E 200E 300E 400E 500E 600E

1200N 1100N 1000N 900N 800N 700N 600N

Reproduced with permission of
Rockford Map Publishers Inc.
Rockford, Illinois